

# MCCONNELSVILLE VILLAGE

BARKER'S ADDITION - 43

SCALE: 1" = 100 FEET

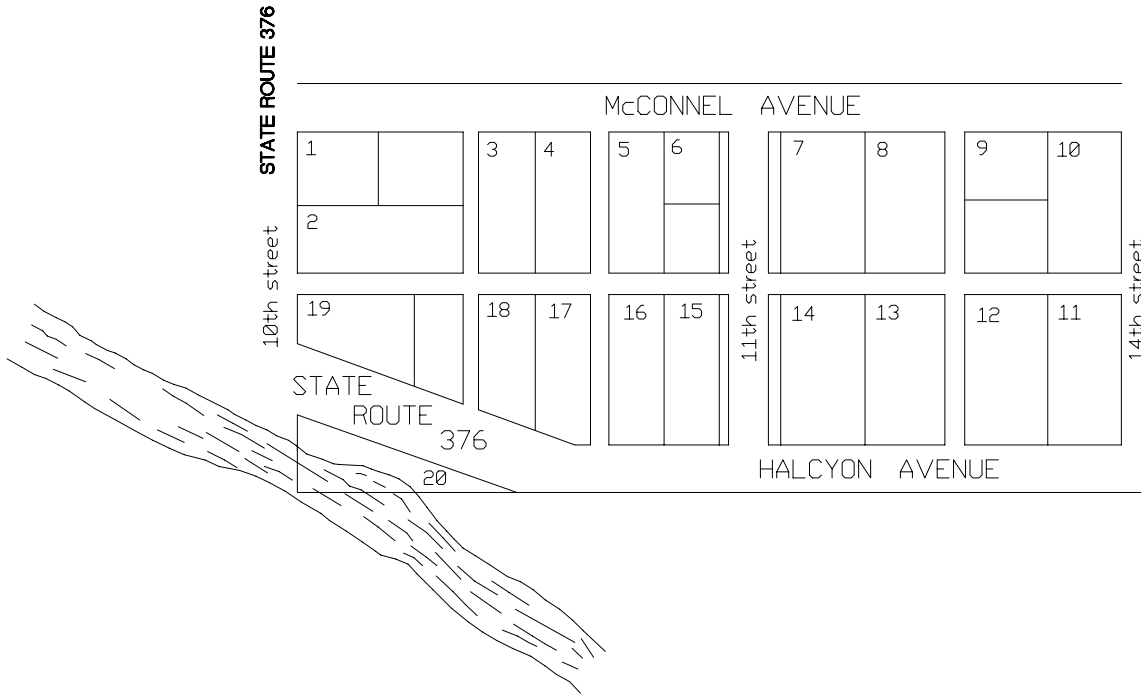

- |     |                            |             |
|-----|----------------------------|-------------|
| 1   | North Eighth LLC west half | OR 202-791  |
|     | Hubert L Hart east half    | OR 206-1761 |
| 2   | Carroll Hale               | OR 81-199   |
| 3   | Ragatz & Vanderwege        | OR 168-214  |
| 4   | Ray Boyd                   | OR 70-30    |
| 5   | Jennifer E Shrivvers       | OR 210-1973 |
| 6   | Martha Bumgardener         | 191-23      |
|     | TRI BA Properties          | OR 134-653  |
| 7   | Dorothy McInturf           | OR 134-140  |
| 8   | Rick Fox                   | OR 205-2264 |
| 9   | Cecil Dawson               | OR 123-80   |
| 9-A | Harlow & Dozer             | OR 149-731  |
| 10  | Doris Wilson               | 196-612     |
| 11  | Harry & Mary Brock         | 126-105     |
| 12  | Barbara Bucey              | OR 187-82   |
| 13  | Eugene & Sonya Hryb        | 167-553     |
| 14  | Eugene & Sonya Hryb        | 167-553     |
| 15  | George White               | OR 98-65    |
| 16  | John Slowter               | OR 133-330  |
| 17  | Douglas R Oliver           | OR 207-1307 |
| 18  | TRI Rentals LTD            | OR 103-62   |
| 19  | Carroll & Leura Hale       | 150-787     |
|     | Jeffery McPeck             | OR 44-506   |
| 20  | ODNR                       |             |