

# BLOOM TOWNSHIP

RANGE 12 TOWNSHIP 11 SECTION 16

NELLE & VELMA SUBDIVISION  
SCALE: 1 INCH = 60 FEET

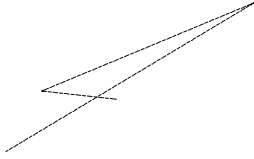
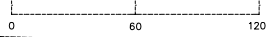

MUSKINGUM  
RIVER

STATE ROUTE 60

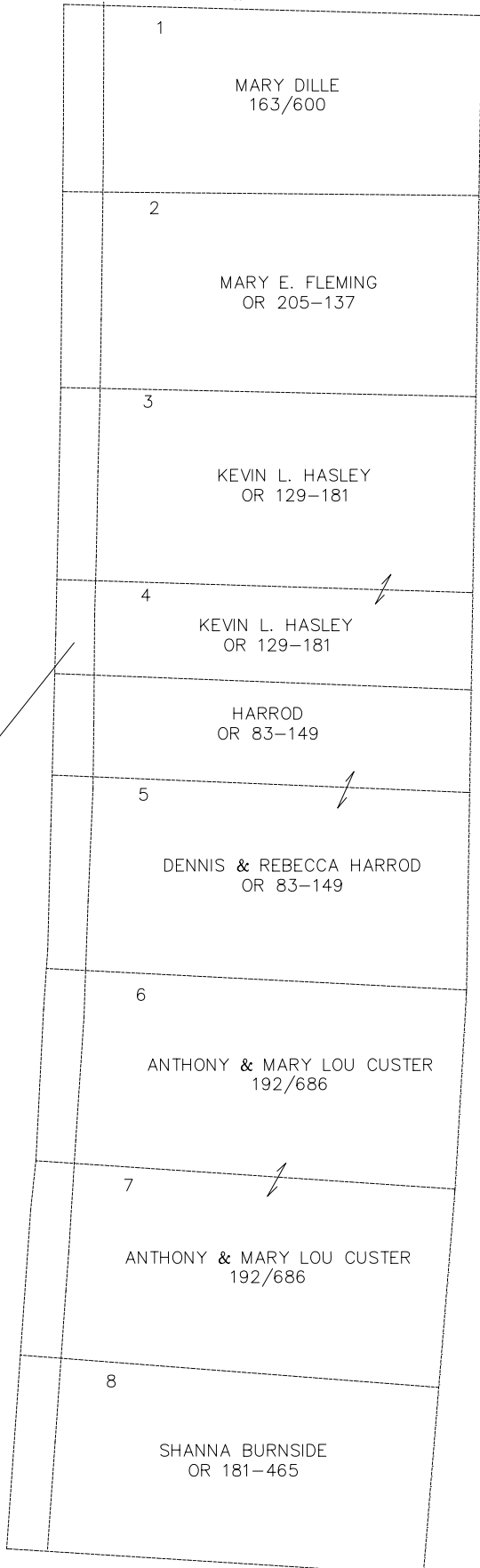

1

MARY DILLE  
163/600

2

MARY E. FLEMING  
OR 205-137

3

KEVIN L. HASLEY  
OR 129-181

4

KEVIN L. HASLEY  
OR 129-181

HARROD  
OR 83-149

5

DENNIS & REBECCA HARROD  
OR 83-149

6

ANTHONY & MARY LOU CUSTER  
192/686

7

ANTHONY & MARY LOU CUSTER  
192/686

8

SHANNA BURNSIDE  
OR 181-465